

SECTION **EX**
EXHAUST SYSTEM

A

EX

C

D

CONTENTS

E

| | | | | |
|---|---|--|---|---|
| PRECAUTION | 2 | ON-VEHICLE REPAIR | 4 | F |
| PRECAUTIONS | 2 | EXHAUST SYSTEM | 4 | |
| Aluminum Die-Casting Parts Handling | 2 | Exploded View | 4 | G |
| ON-VEHICLE MAINTENANCE | 3 | Removal and Installation (GT-R certified NISSAN dealer) | 4 | H |
| EXHAUST SYSTEM | 3 | Inspection (GT-R certified NISSAN dealer) | 5 | |
| Inspection (GT-R certified NISSAN dealer) | 3 | | | |

H

I

J

K

L

M

N

O

P

www.gtr-store.eu

PRECAUTIONS

< PRECAUTION >

PRECAUTION

PRECAUTIONS

Aluminum Die-Casting Parts Handling

INFOID:000000004040384

PROHIBITION OF WELDING OR BEATING REPAIR

- Material made of aluminum die-casting parts is heat-treated and loses strength when being exposed to welding heat. Do not perform welding repair for cracks, damage or others.
- For aluminum die-casting parts deformation, do not perform repair by beating. Always repair by replacement as an assembly.

CRACK CHECK

When the vehicle is damaged, always perform a visual deformation check and a crack check.

Crack Check Procedures

For a crack check, use dye penetrant inspection fluid (pre-cleaning fluid, penetrant fluid and developer fluid).

CAUTION:

Always perform a crack check in accordance with the procedures specified by the manufacturer of the dye penetrant inspection fluid.

1. Spray pre-cleaning fluid on the checking surface for cleaning.
2. Spray penetrant fluid on the checking surface and wait until the penetrant fluid soaks into any cracks.
3. Wipe off excessive penetrant fluid, and then also lightly wipe off penetrant fluid using a wet cloth.
4. Spray developer fluid on the checking surface.
5. Cracks, if any, are dyed red in color.

STRAY CURRENT CORROSION

- Corrosion occurs to aluminum die-casting parts by the stray current corrosion phenomenon, when directly contacting other parts made of steel. Always apply anti-stray current corrosion paint (primer) on the mounting surface.
- Clean mounting surface to prevent any foreign matter, steel powder or others from being mixed in. Always apply the specified adhesive when installing.
- Corrosion by stray current corrosion may occur when installing with any other bolts than the specified bolt. Always use the specified bolt that is surface treated.
- When loosening the specified bolt that is tightened, the treated surface may peel. Never reuse the specified bolt that is tightened once.

TIGHTENING TORQUE CONTROL

Material made of aluminum die-casting parts is soft in term of hardness. Tightening torque must be controlled exactly as specified. Always use a torque wrench to install any part to the specified tightening torque.

WARNING:

Never use a power tool to remove or tighten bolts for aluminum die-casting part.

EXHAUST SYSTEM

< ON-VEHICLE MAINTENANCE >

ON-VEHICLE MAINTENANCE

EXHAUST SYSTEM

Inspection (GT-R certified NISSAN dealer)

INFOID:000000003867238

Check exhaust pipes, muffler, and mounting for improper attachment, leakage, cracks, damage or deterioration.

- If anything is found, repair or replace damaged parts.

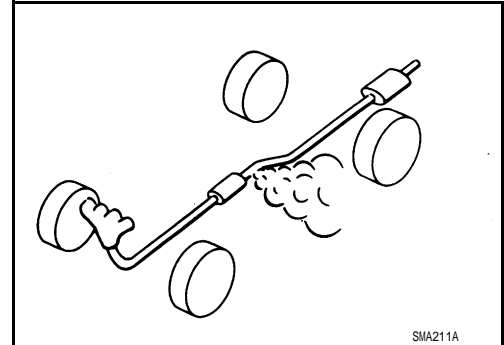

A

EX

C

D

E

F

G

H

I

J

K

L

M

N

O

P

www.gtr-store.eu

EXHAUST SYSTEM

< ON-VEHICLE REPAIR >

ON-VEHICLE REPAIR

EXHAUST SYSTEM

Exploded View

INFOID:000000003867239

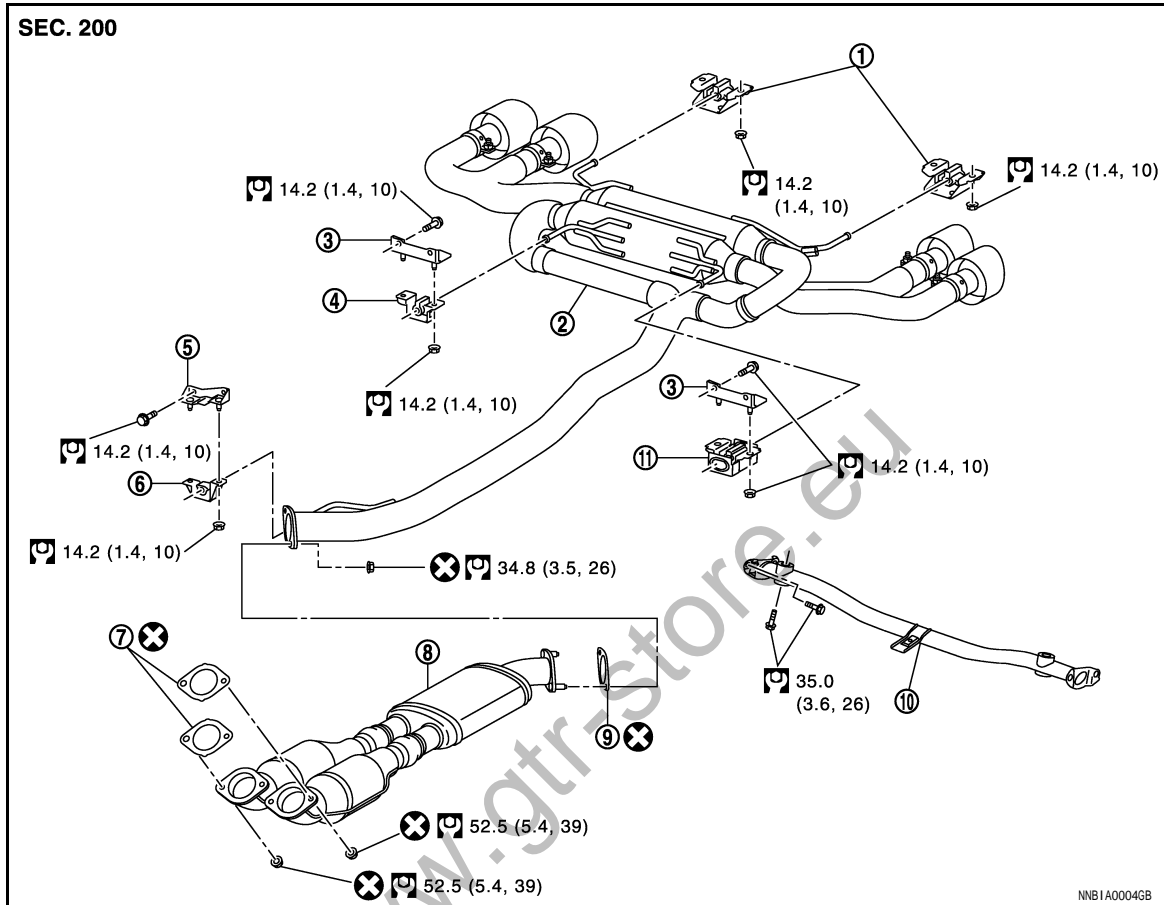

NWB1A00046B

- | | | |
|----------------------------------|-----------------------------------|-----------------------------|
| 1. Mounting bracket (No. 4) | 2. Main muffler assembly | 3. Bracket |
| 4. Mounting bracket (No. 3) (RH) | 5. Bracket | 6. Mounting bracket (No. 2) |
| 7. Gasket | 8. Sub muffler | 9. Gasket |
| 10. Front cross bar assembly | 11. Mounting bracket (No. 3) (LH) | |

Refer to [GI-4. "Components"](#) for symbols in the figure.

Removal and Installation (GT-R certified NISSAN dealer)

INFOID:000000003867240

CAUTION:

- Be sure to use genuine exhaust system parts or equivalents which are specially designed for heat resistance, corrosion resistance, and shape.
- Perform the operation with the exhaust system fully cooled down because the system is hot just after engine stops.
- Be careful not to cut hand on the heat insulator edge.
- Never disassemble main muffler assembly.

REMOVAL

1. Remove rear bumper. Refer to [EXT-19. "Exploded View"](#).
2. Remove front cross bar assembly.
3. Remove the nuts fixing main muffler assembly and sub muffler.
4. Remove the nuts fixing sub muffler and catalyist.
5. Remove sub muffler.

EXHAUST SYSTEM

< ON-VEHICLE REPAIR >

6. Remove the nuts from each mounting bracket.
7. Remove main muffler assembly.

CAUTION:

Be careful not to bump main muffler assembly against its surrounding parts.

INSTALLATION

CAUTION:

- Always replace exhaust tube gaskets with new ones when reassembling.
- If heat insulator is badly deformed, repair or replace it. If deposits such as mud pile up on the heat insulator, remove them.
- Remove deposits from the sealing surface of each connection. Connect them securely to avoid gases leakage.
- Temporarily tighten mounting bolts and nuts. Check each part for unusual interference, and then tighten them to the specified torque.
- When installing each mounting bracket, avoid twisting or unusual extension in up/down and right/left directions.

1. Install mounting brackets to main muffler assembly, checking the front mark of mounting brackets.
2. Install main muffler assembly.

CAUTION:

Be careful not to bump main muffler assembly against its surrounding parts (rear suspension member etc.).

3. Temporarily tighten the nuts of each mounting brackets.
4. Install sub muffler, and then temporarily tighten the nuts fixing main muffler assembly and sub muffler.
5. Temporarily tighten the nuts fixing sub muffler and catalyst.
6. Tighten the nuts mounting bracket (No. 4) to the specified torque.
7. Tighten the nuts mounting bracket (No. 3) to the specified torque.
8. Tighten the nuts mounting bracket (No. 2) to the specified torque.
9. Tighten the nuts fixing main muffler assembly and sub muffler to the specified torque.
10. Tighten the nuts fixing sub muffler and catalyst to the specified torque.
11. Install all the remaining parts in the reverse order of removal.

Inspection (GT-R certified NISSAN dealer)

INFOID:000000003867241

INSPECTION AFTER REMOVAL

- Check that the muffler finisher installation position, referring to the figure.

- A : Under view
B : Protrusion (main muffler assembly side)
c : 28 mm (1.10 in)
⇐ : Vehicle front

CAUTION:

Be sure to correct the installation position if it is different from the position shown in the figure.

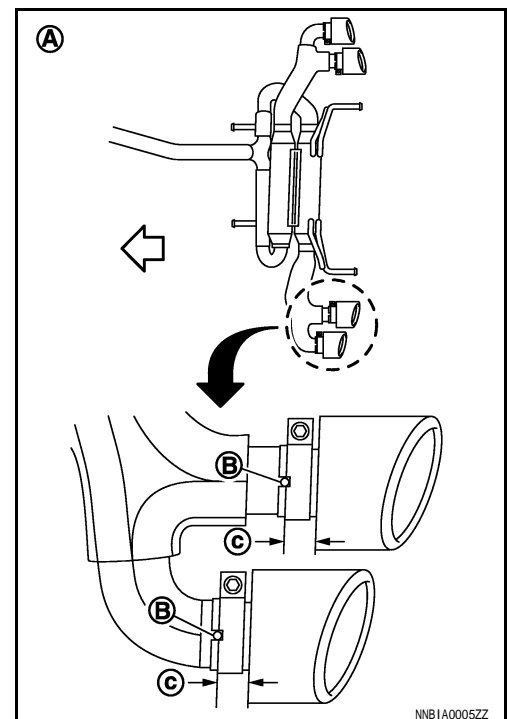

EXHAUST SYSTEM

< ON-VEHICLE REPAIR >

INSPECTION AFTER INSTALLATION

- Check that clearance between muffler finisher and rear bumper is even.
- If the clearance is not even, reinstall main muffler assembly.

CAUTION:

When reinstalling main muffler assembly, check the muffler finisher installation position. Refer to “INSPECTION AFTER REMOVAL”.

- With engine running, check exhaust tube joints for gas leakage and unusual noise.
- Check to ensure that mounting brackets are installed properly and free from undue stress. Improper installation may result in excessive noise and vibration.

www.gtr-store.eu